

### BB73201x – Bridge bars for deep boring

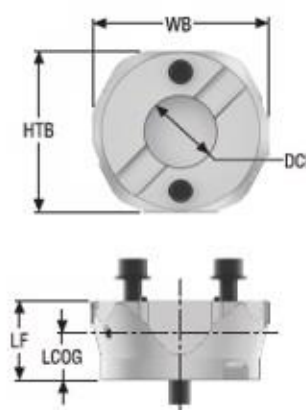

- To be mounted on a Steadyliner® shell mill holder spigot 40 mm, see page(s) 597
- Coolant through the Bridge bar

Designation	Item number	DCN	DCX	HTB	WB	DCB	LF	LCOG	Weight
		mm	mm	mm	mm	mm	mm	mm	kg
		Inch	Inch	Inch	Inch	Inch	Inch	Inch	lbs
SM40-BB732-011	10270854	114,0	146,0	90,0	98,0	40,0	44,0	25,39	2,0
		4.488	5.748	3.543	3.858	1.575	1.732	1.000	4.4
SM40-BB732-012	10270855	145,0	177,0	90,0	129,0	40,0	44,0	25,46	2,9
		5.709	6.969	3.543	5.079	1.575	1.732	1.002	6.4
SM40-BB732-013	10270856	176,0	208,0	104,0	160,0	40,0	35,0	20,95	2,9
		6.929	8.189	4.094	6.299	1.575	1.378	0.825	6.4
SM40-BB732-014	10270857	207,0	239,0	104,0	191,0	40,0	35,0	21,22	3,6
		8.150	9.409	4.094	7.520	1.575	1.378	0.835	7.9
SM40-BB732-015	10270858	238,0	270,0	104,0	222,0	40,0	35,0	21,38	4,2
		9.370	10.630	4.094	8.740	1.575	1.378	0.842	9.3
SM40-BB732-016	10270859	269,0	301,0	104,0	253,0	40,0	35,0	21,5	4,8
		10.591	11.850	4.094	9.961	1.575	1.378	0.846	10.6

Tightening torque 100 Nm (74 lbf. ft)



For application details, refer to the operating instructions supplied with the Bridge bars and boring blocks.

Max RPM, see page(s) 590

### Spare Parts, included in delivery

For	Kit
	
SM40..011	90BB01
SM40..012	90BB01
SM40..013	90BB02
SM40..014	90BB02
SM40..015	90BB02
SM40..016	90BB02

### Accessories

For	Clamp key	Locking key
		
SM40..011	03HL10	03HL08
SM40..012	03HL10	03HL08
SM40..013	03HL10	03HL08
SM40..014	03HL10	03HL08
SM40..015	03HL10	03HL08
SM40..016	03HL10	03HL08

### BB732 – Rough and fine boring blocks for BB732 bridge bars

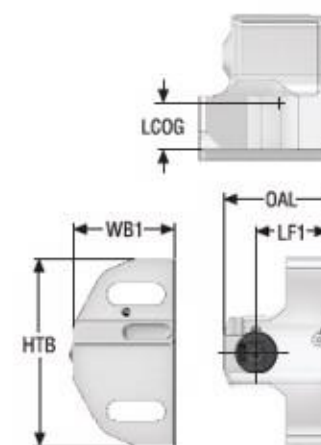
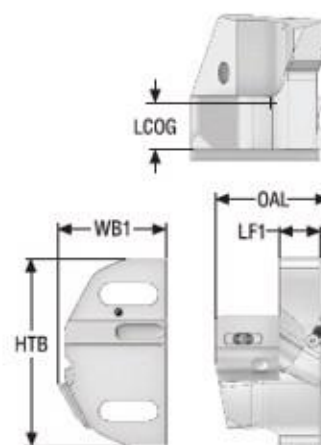

- To be assembled on BB732 bridge bars
- Coolant through rough and fine boring blocks
- A rough boring assembly requires two rough boring blocks
- A fine boring assembly requires one fine boring block and one counterweight

Designation	Item number	Type of boring block	Workpiece side Capacity DCN-DCX Ø		LCOG	HTB	OAL	LF1	WB1	Weight
			mm	mm						
			Inch	Inch	mm	mm	mm	mm	mm	kg
			Inch	Inch	Inch	Inch	Inch	Inch	Inch	lbs
BB732-RB400	10270863	Rough boring block	114,0	301,0	16,04	90,0	54,5	20,0	52,0	0,7
			4.488	11.850	0.631	3.543	2.146	0.787	2.047	1.5
BB732-FB500	10270864	Fine boring block	114,0	315,0	17,97	90,0	54,0	34,5	48,95	0,8
			4.488	12.402	0.707	3.543	2.126	1.358	1.927	1.8
BB732-FB600	10270865	Counterweight	114,0	315,0	18,36	90,0	54,0	–	48,95	0,8
			4.488	12.402	0.723	3.543	2.126		1.927	1.8

Cartridges to be ordered separately, see page(s) 589

### Spare Parts, included in delivery

For	Kit
	
BB732-RB400	–
BB732-FB500	90FB00
BB732-FB600	–

### Accessories

For	Allen key	Locking key	Torque key
			
BB732-RB400	03H03	03HL08	H00T-50100
BB732-FB500	–	03HL08	H00-3030
BB732-FB600	03H03	03HL08	–